



Profit from the Eagle Advantage®

Specification Sheet

Short Form Specifications

Eagle Pass-Thru Ice Chest, model _____. Top, front and sides to be heavy gauge stainless steel. Fully insulated, with 1½" stainless steel drain and tail piece. Stainless steel sliding cover is standard. Available with sealed-in 7-circuit cold plate. 1½" O.D. galvanized legs with adjustable bullet feet.



pass thru ice chest

Options / Accessories

- Stainless steel leg kits

EAGLE GROUP
100 Industrial Boulevard, Clayton, DE 19938-8903 USA
Phone: 302-653-3000 • Fax: 302-653-2065
www.eaglegrp.com

Foodservice Division: Phone 800-441-8440
MHC/Retail Display Divisions: Phone 800-637-5100

For custom configuration or fabrication needs, contact our **SpecFAB® Division**.
Phone: 302-653-3000 • Fax: 302-653-3091 • e-mail: specfab@eaglegrp.com

Item No.: _____
Project No.: _____
S.I.S. No.: _____

Pass-Thru Ice Chests for 1800 and 2200 Series Underbar Equipment

MODELS:

- B18ICPT
- B18ICPT-7
- B24ICPT
- B24ICPT-7

Design and Construction Features

- Heavy gauge stainless steel body, front, and sides.
- 1½" (38mm) stainless steel drain with tail piece standard.
- Fiberglass insulation.
- Available with 7-circuit post-mix cold plate, featuring foamed-in-place insulation and ½" (13mm) NPS pipe nipple drain.
- Sliding cover standard on all models.
- Legs are heavy gauge 1½" (41mm)-diameter galvanized steel with adjustable feet.
- Available in widths of 18" and 24" (457 and 610mm).
- All models are 36" (914mm) front-to-back.
- Optional stainless steel leg kits available.



Spec sheets available for viewing, printing or downloading from our online literature library at www.eaglegrp.com



Item No.: _____
 Project No.: _____
 S.I.S. No.: _____

Pass-Thru Ice Chests for 1800 and 2200 Series Underbar Equipment

#B18ICPT

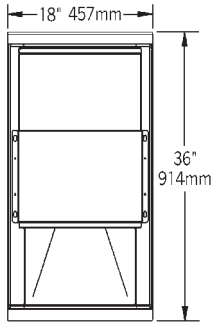

TOP VIEW

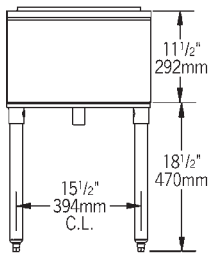

FRONT VIEW

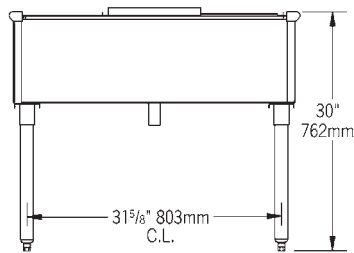

SIDE VIEW

#B24ICPT

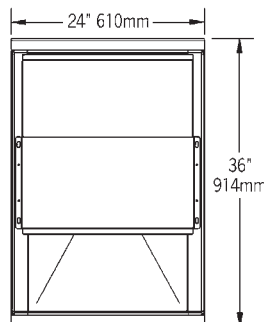

TOP VIEW

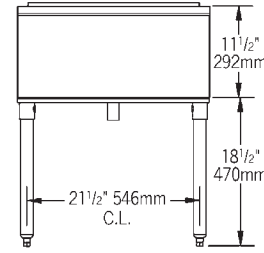

FRONT VIEW

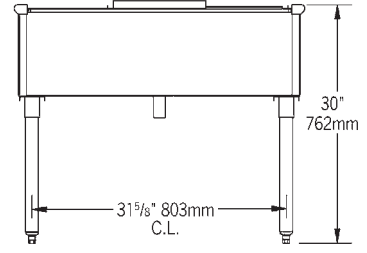

SIDE VIEW

model #	side-to-side		front-to-back		weight	
	in.	mm	in.	mm	lbs.	kg
B18ICPT	18"	457	36"	914	70	31.8
B18ICPT-7 *	18"	457	36"	914	106	48.1
B24ICPT	24"	610	36"	914	85	38.6
B24ICPT-7 *	24"	610	36"	914	121	54.9

* 7-circuit post-mix cold plate included

Optional Stainless Steel Leg Kits

add suffix #	description
-SL	stainless steel leg assemblies
-SLF	stainless steel leg assemblies & stainless steel feet
-SLG	stainless steel leg assemblies & stainless steel gussets
-SLGF	stainless steel leg assemblies, stainless steel feet & gussets

EAGLE GROUP
 100 Industrial Boulevard, Clayton, DE 19938-8903 USA
 Phone: 302-653-3000 • Fax: 302-653-2065
 www.eaglegrp.com

Foodservice Division: Phone 800-441-8440
 MHC/Retail Display Divisions: Phone 800-637-5100

Printed in U.S.A.
 ©2010 by Eagle Group
 Rev. 06/10

Spec sheets available for viewing, printing or downloading from our online literature library at www.eaglegrp.com

Although every attempt has been made to ensure the accuracy of the information provided, we cannot be held responsible for typographical or printing errors. Information and specifications are subject to change without notice. Please confirm at time of order.